

INTRODUCING WILLS WHARF

Trophy waterfront office space now
leasing at Baltimore's Harbor Point

HARBOR • POINT





HIGHLIGHTS

Positioned at the gateway to Baltimore's Inner Harbor, Wills Wharf is a mixed-use building, offering more than 330,000 SF of premiere office and hotel space, all while providing stunning waterfront views.

- 236,000 SF Class A office space
- 156 hotel rooms (Canopy by Hilton)
- LEED® Gold core and shell
- Unparalleled waterfront views
- Neighborhood setting
- Proximity to amenities and open spaces
- Flexible floorplates designed for productivity and efficiency
- \$10.2 million in estimated enterprise zone credits

WILLS WHARF & NEIGHBORING CORPORATE TENANTS



Wealth
Management



T.RowePrice®



Jellyfish



Morgan Stanley

This is Harbor Point

Harbor Point is Baltimore's next great waterfront neighborhood. The 27-acre site seamlessly blends office, retail, residences, hotels, and an unprecedented amount of green space into a dynamic new extension of the city.

Harbor Point is perfectly located at the nexus of some of Baltimore's most exciting neighborhoods: vibrant Harbor East and historic Fell's Point.

1 HARBOR EAST

- 24+ RESTAURANTS
- 25+ UPSCALE SHOPS
- 4 HOTELS

2 FELL'S POINT

- 100+ RESTAURANTS & PUBS
- 100+ SHOPS & SERVICES
- 11 HOTELS

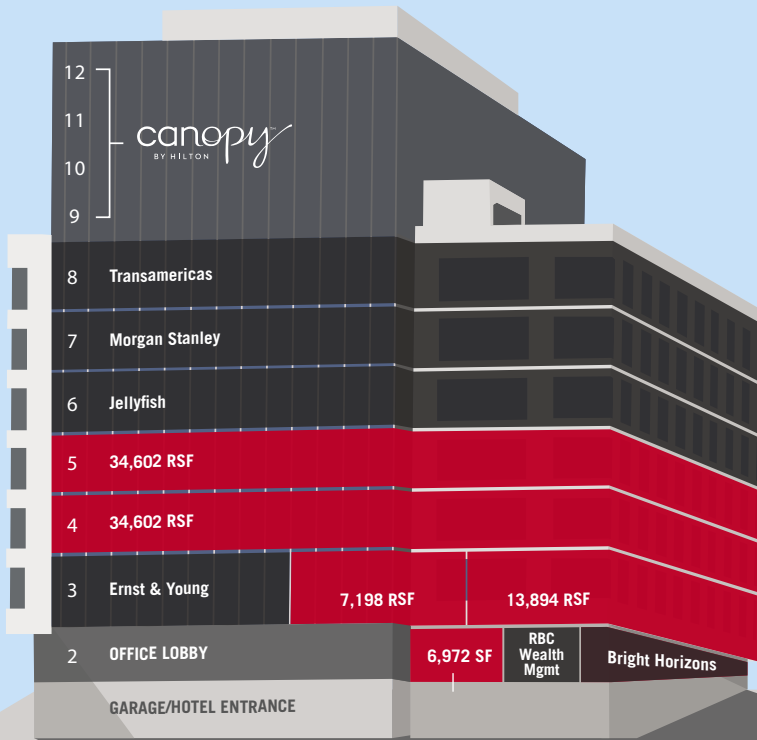

34,602 SF
Typical Floor Plan

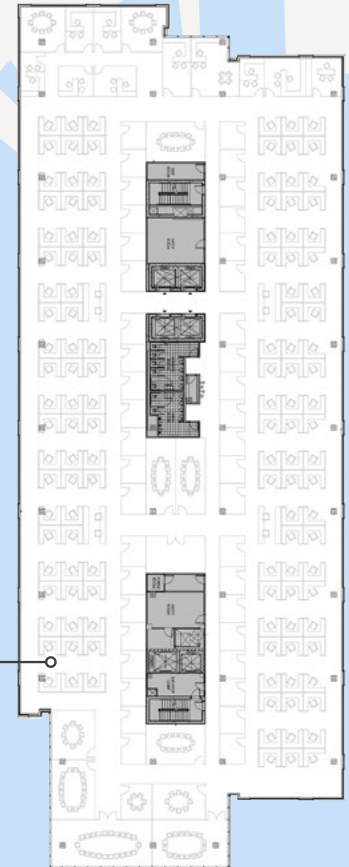

WALK SCORE®
89
(Very Walkable)

HARBOR POINT BY THE NUMBERS

27	3M	1.6M	250,000	2,500	600+	3,300	9.5
acres	SF total development	SF office	SF retail	residential units	hotel rooms	parking spaces	acres of open space

For leasing information, contact:

Rob Freedman
443 931 3346
rob.freedman@am.jll.com

Peter Jackson
+1 443 931 3329
peterm.jackson@am.jll.com



Follow us @HarborPointMD



Disclaimer: Although information has been obtained from sources deemed reliable, Owner, Jones Lang LaSalle, and/or their representatives, brokers or agents make no guarantees as to the accuracy of the information contained herein, and offer the Property without express or implied warranties of any kind. The Property may be withdrawn without notice.

© 2020. Jones Lang LaSalle. All rights reserved.